

**EXISTING**

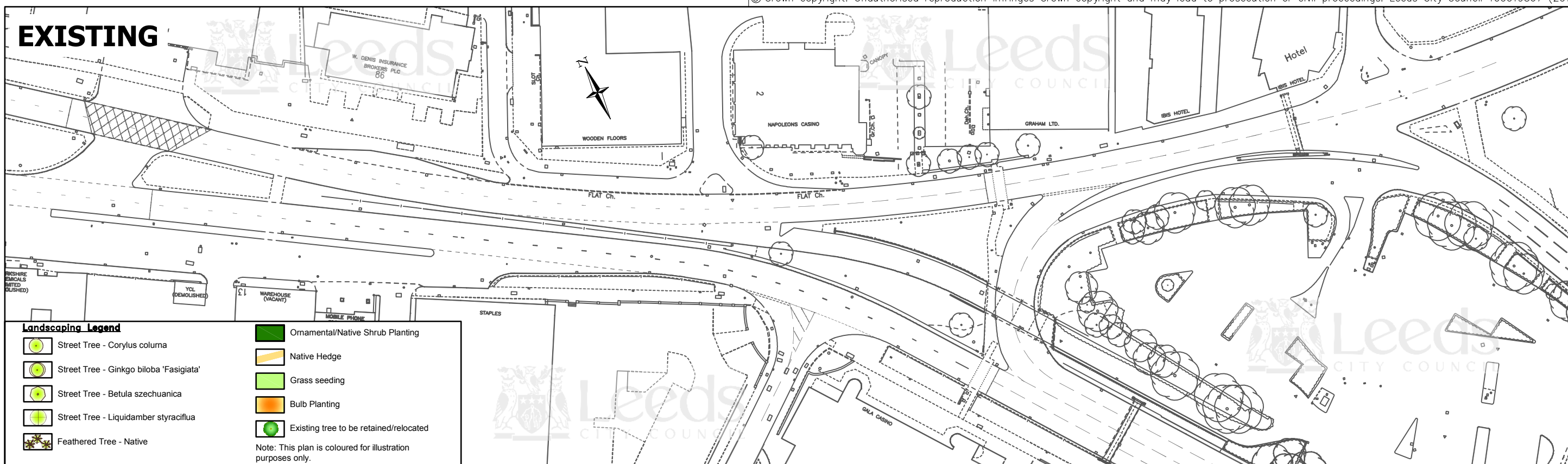

**Landscaping Legend**

Street Tree - Corylus colurna	Ornamental/Native Shrub Planting
Street Tree - Ginkgo biloba 'Fasigiata'	Native Hedge
Street Tree - Betula szechuanica	Grass seeding
Street Tree - Liquidamber styraciflua	Bulb Planting
Feathered Tree - Native	Existing tree to be retained/relocated

Note: This plan is coloured for illustration purposes only.

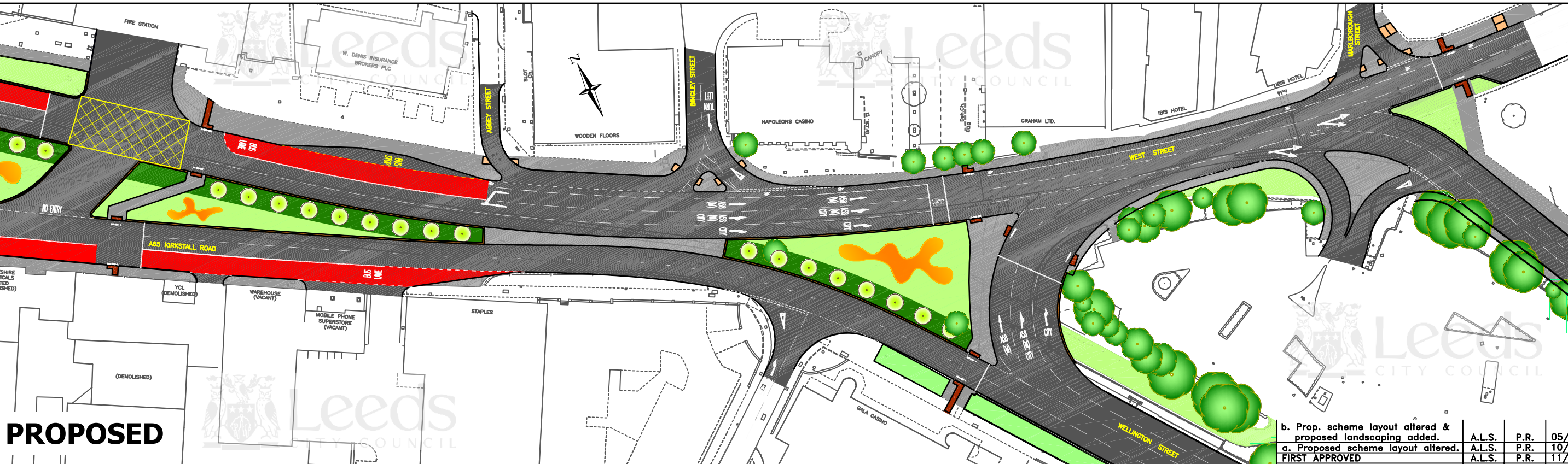

**PROPOSED**

b. Prop. scheme layout altered & proposed landscaping added.	A.L.S.	P.R.	05/10
a. Proposed scheme layout altered.	A.L.S.	P.R.	10/09
FIRST APPROVED	A.L.S.	P.R.	11/08
AMENDMENTS	DRAWN	CHECK	DATE

**A65 KIRKSTALL ROAD  
QUALITY BUS INITIATIVE  
EXISTING AND PROPOSED LAYOUT  
SHEET 10 OF 10**

This drawing is the property of Leeds City Council. It must only be used for the purpose for which it was originally supplied. It must not be copied, published or transmitted by any means to any third party, without the express permission of the originator. Modification or manipulation of all or part of this drawing is strictly forbidden unless specifically requested or approved by the originator.

	INITIALS	DATE	SCALE
DRAWN BY	A.L.S.	05/10	1:1000
AutoCAD BY	A.L.S.	05/10	
CHECKED BY	P.R.	05/10	

**Leeds**  
CITY COUNCIL  
HIGHWAYS AND TRANSPORTATION

DRAWING NUMBER:	HDC/713184/WP/10B
DATE:	May 2010